

# 1 Explosionszeichnung / Exploded drawing / Vue éclatée OR-T 670

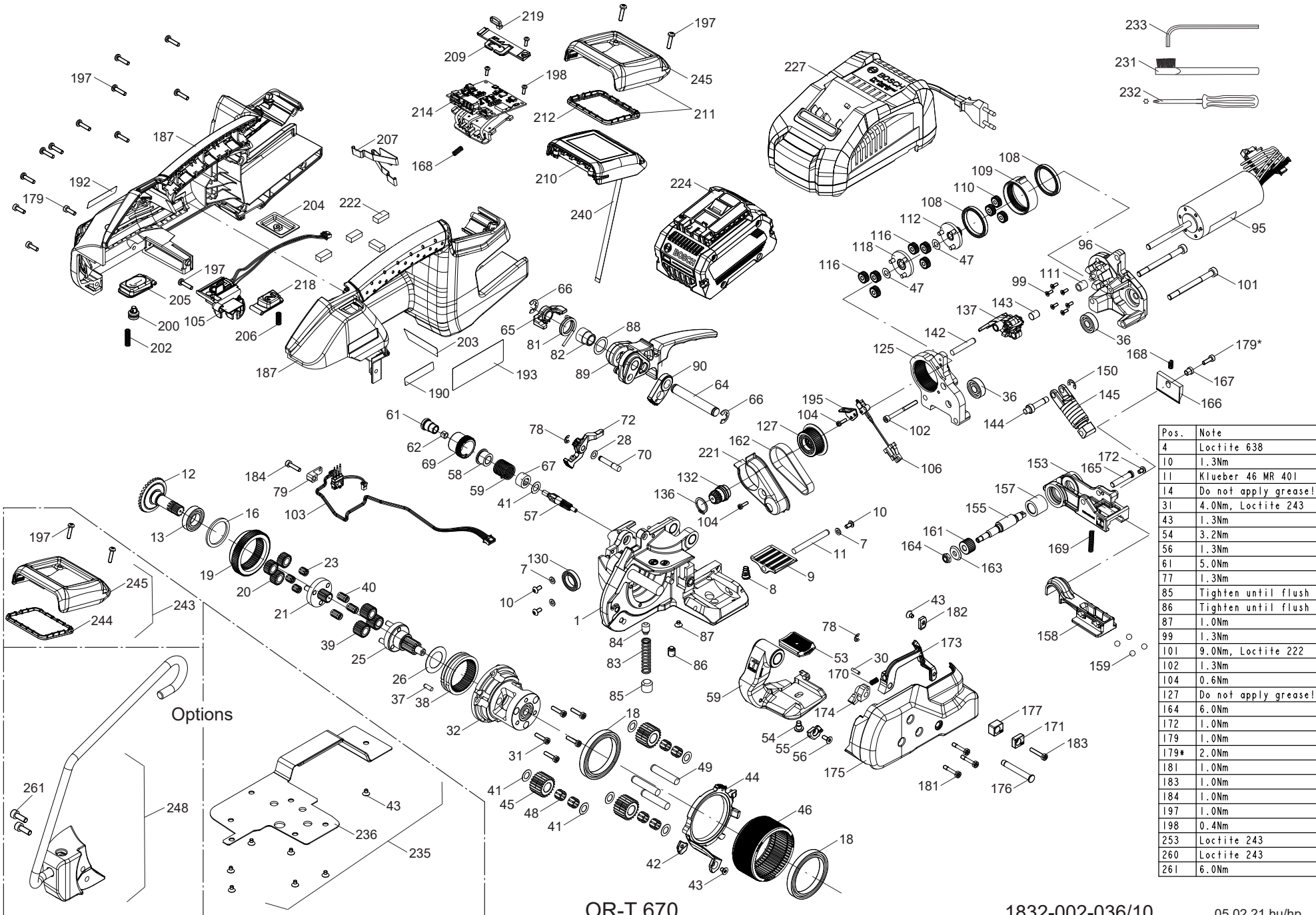

Pos.	Note
4	Loctite 638
10	1.3Nm
11	Klueber 46 MR 401
14	Do not apply grease!
31	4.0Nm, Loctite 243
43	1.3Nm
54	3.2Nm
56	1.3Nm
61	5.0Nm
77	1.3Nm
85	Tighten until flush
86	Tighten until flush
87	1.0Nm
99	1.3Nm
101	9.0Nm, Loctite 222
102	1.3Nm
104	0.6Nm
127	Do not apply grease!
164	6.0Nm
172	1.0Nm
179	1.0Nm
179*	2.0Nm
181	1.0Nm
183	1.0Nm
184	1.0Nm
197	1.0Nm
198	0.4Nm
253	Loctite 243
260	Loctite 243
261	6.0Nm

OR-T 670

1832-002-036/10

05.02.21 hu/hp